

INTERMEDIATE & TRUCK MOUNTED MACHINE TIPS (KC-700)				
TIP NUMBER	MINOR	MAJOR	DRIFICE SIZE (IN.)	MIL THICKNESS
XHD-437	4"	8"	.037"	15
XHD-439	4"	8"	.039	15
XHD-443	4"	8"	.043"	15
XHD-447	4"	8"	.047"	15
XHD-449	4"	8"	.049"	15
XHD-451	4"	8"	.051"	15
XHD-455	4"	8"	.055"	15
XHD-461	4"	8"	.061"	15
XHD-651	6"	12"	.051"	15
XHD-739	7"	14"	.039"	15
XHD-751	7"	14"	.051"	15
XHD-001	TIP GUARD			

TOLERANCES UNLESS OTHERWISE SPECIFIED:
 Angular $\pm 2^\circ$
 Fractional $\pm 1/16"$
 .X = ± 1
 .XX = ± 0.1
 .XXX = ± 0.005
 .XXXX = ± 0.0015

CONFIDENTIAL
 THIS DOCUMENT, INCLUDING ALL INFORMATION HEREIN, IS THE EXCLUSIVE AND CONFIDENTIAL PROPERTY OF ERNEST INDUSTRIES. THEREFORE THIS DOCUMENT IS NOT TO BE COPIED, REPRODUCED, OR DELIVERED TO OTHERS WITHOUT THE EXPRESS WRITTEN PERMISSION OF ERNEST INDUSTRIES.

Kelly-Creswell
 1221 Groop Rd.
 Springfield, OH 45504
 937-325-3978
KC Since 1937

DRAWN BY
 CDW
 APPROVED BY

DATE
 11-9-10
 DATE APPROVED

TITLE:
WV-50C-AL

DESCRIPTION:
GENERAL LAYOUT

DWG NO./PART NO.
WV50 CUSHMAN MANUAL PRINTS

SCALE: N/A

SIZE: A

PAGE #: 1-3

REV: A

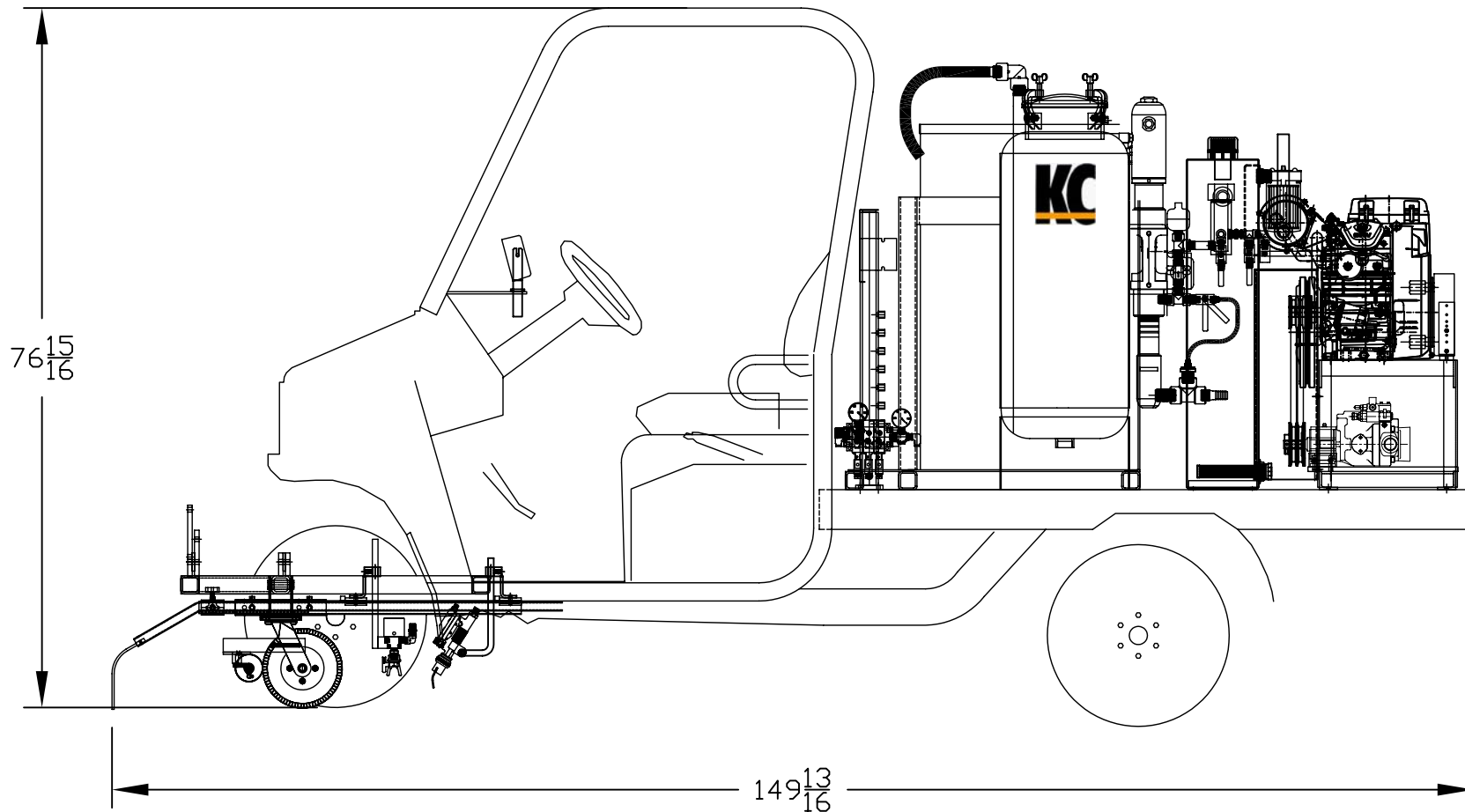

LENGTH (INCHES)	149"
HEIGHT (INCHES)	76.9"
WIDTH (INCHES)	
TRANSPORT POSITION	85"
STRIPING POSITION	89"
EST. SHIPPING WEIGHT	2500 LBS

TOLERANCES UNLESS OTHERWISE SPECIFIED:
 Angular ±2°
 Fractional ±1/16"
 .X = ±.1
 .XX = ±.01
 .XXX = ±.005
 .XXXX = ±.0015

CONFIDENTIAL
 THIS DOCUMENT, INCLUDING ALL INFORMATION HEREIN, IS THE EXCLUSIVE AND CONFIDENTIAL PROPERTY OF ERNEST INDUSTRIES. THEREFORE THIS DOCUMENT IS NOT TO BE COPIED, REPRODUCED, OR DELIVERED TO OTHERS WITHOUT THE EXPRESS WRITTEN PERMISSION OF ERNEST INDUSTRIES.

Kelly-Creswell
 1221 Groop Rd.
 Springfield, OH 45504
 937-325-3978

KC Since 1937

DRAWN BY: CDW
 DATE: 11-9-10
 APPROVED BY: _____
 DATE APPROVED: _____

TITLE: WV-50C-AL			
DESCRIPTION: BASIC DIMENSIONS			
DWG NO./PART NO. WV CUSHMAN MANUAL PRINTS			
SCALE: N/A	SIZE: A	PAGE #: 2-3	REV: A

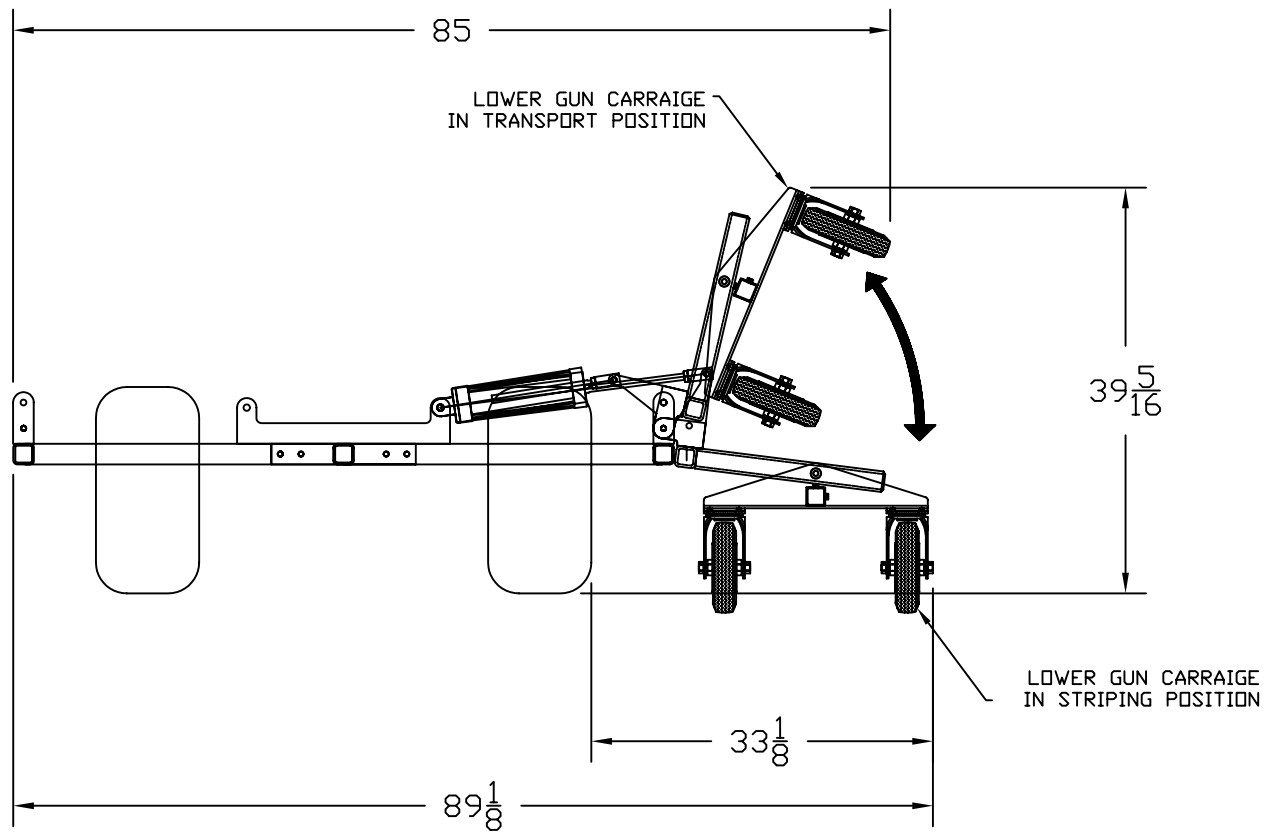

TOLERANCES UNLESS OTHERWISE SPECIFIED:
 Angular ±2°
 Fractional ±1/16"
 .X= ±.1
 .XX=±.01
 .XXX=±.005
 .XXXX=±.0015

CONFIDENTIAL
 THIS DOCUMENT, INCLUDING ALL INFORMATION HEREIN, IS THE EXCLUSIVE AND CONFIDENTIAL PROPERTY OF ERNEST INDUSTRIES. THEREFORE THIS DOCUMENT IS NOT TO BE COPIED, REPRODUCED, OR DELIVERED TO OTHERS WITHOUT THE EXPRESS WRITTEN PERMISSION OF ERNEST INDUSTRIES.

Kelly-Creswell
 1221 Groop Rd.
 Springfield, OH 45504
 937-325-3978



DRAWN BY CDW	DATE 11-9-10
APPROVED BY	DATE APPROVED

TITLE: WV-50C-AL			
DESCRIPTION: BASIC DIMENSIONS			
DWG NO./PART NO. WV50 CUSHMAN MANUAL PRINTS			
SCALE: N/A	SIZE: A	PAGE #: 3-3	REV: A